

GENERAL SCHEDULE OF PARALLEL SESSION (RCCE-ICCER 2017)

VENUE	BALLROOM 1	BALLROOM 2	TANG PALACE	JAVA	CELEBES	BANDA	BALI A	BALI B	BALI C
PARALLEL SESSION I									
MODERATOR	BUDI SUSWANTO	DATA IRANATA	ENDAH W	IPUNG	NADAJAJI	HERA	NOOR ENDAH	PUTU ARTAMA	CHRISTIONO U
13.30 - 13.45	1	2	27	6	19	7	5	40	15
13.45 - 14.00	20	12	84	52	21	24	16	50	30
14.00 - 14.15	33	67	88	158	22	41	32	55	31
14.15 - 14.30	60	72	108	163	37	87	45	110	34
14.30 - 14.45	77	100	121	91	124	106	105	130	59
14.45 - 15.00	78	164	154	142	152	112	178	145	71
15.00 - 15.15	BREAK								
PARALLEL SESSION II									
MODERATOR	BUDI SUSWANTO	DATA IRANATA	MUDJI	BIEBY	UMBORO	INDRASURYA	YUDHI	TRIJOKO	CHRISTIONO U
15.15 - 15.30	18	9	167	46	49	36	25	4	74
15.30 - 15.45	79	13	98	92	64	58	51	23	111
15.45 - 16.00	81	85	117	99	66	89	61	39	141
16.00 - 16.15	102	90	127	131	107	168	136	93	144
16.15 - 16.30	118	116	160	138	120	169	137	113	150
16.30 - 16.45	119	140	176	183	146	172	182	151	175
16.45 - 17.00	CLOSING								

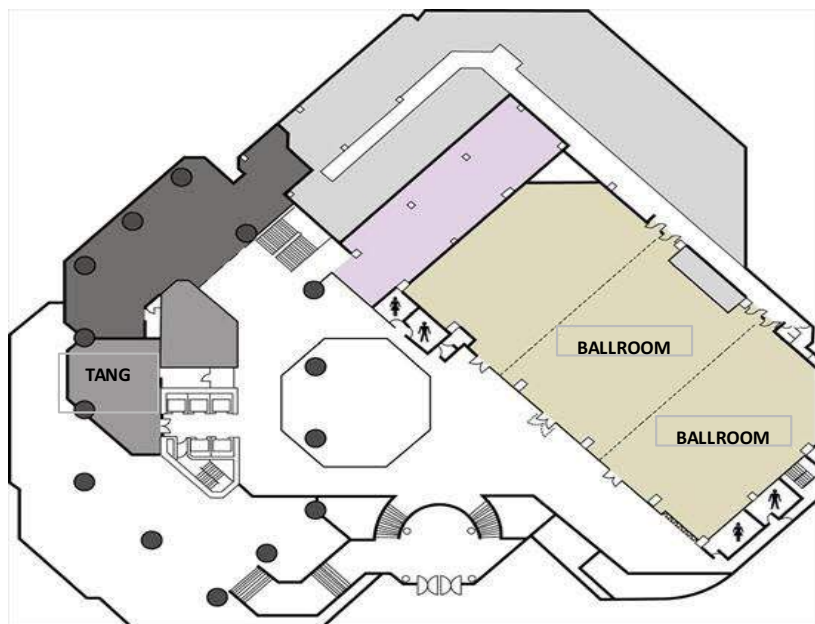

NO	VENUE	
1	BALLROOM 1	2nd floor
2	BALLROOM 2	2nd floor
3	TANG PALACE	2nd floor
4	JAVA	3rd floor
5	CELEBES	3rd floor
6	BANDA	3rd floor
7	BALI A	3rd floor
8	BALI B	3rd floor
9	BALI C	3rd floor
10	BOARD ROOM	3rd floor

DETAILED SCHEDULE OF PARALLEL SESSION BASED ON PAPER IDS

VENUE : BALLROOM I (2nd floor)			
MODERATOR : BUDI SUSWANTO, ST., MT., PhD			
SESSION I			
No	Name	Presenter	Abstract Title
1	Luong Van Hai, Cao Tan Ngoc Than, Nguyen Xuan Vu and Tran Minh Thi	Luong Van Hai	DYNAMIC ANALYSIS OF MINDLIN PLATES RESTING ON A VISCOELASTIC FOUNDATION SUBJECTED TO MOVING LOADS DURING ABRUPT BRAKING USING MOVING ELEMENT METHOD
20	Bernardo Lejano and Michael Mas	Bernardo Lejano	Numerical study on the effect of structural parameters on the behavior of BRBF-E
33	Thinzar Khaing, Yu Yu Kyi Win and Nyan Myint Kyaw	Thinzar Khaing	Study on Rust Characterization and Prediction of Atmospheric Corrosion Rates for Structural Steels in Yangon (Myanmar)
60	Adi Mulya Sanjaya	Adi Mulya Sanjaya	SEISMIC PERFORMANCES OF HIGH RISE R/C FRAME STRUCTURES REINFORCED WITH HIGH STRENGTH REBARS
77	Bunya Chea, Taweeep Chaisomphob, Wasan Patwichaichote and Eiki Yamaguchi	Wasan Patwichaichote	Experimental and Numerical Analysis on Cold-formed Steel Built-up Box Beam
78	Muslinang Moestopo, Dyah Kusumastuti, Erwin Lim, Akbar Undagi and Ramadhita Mega	Akbar Undagi	Application of Seismic Devices For Core Frames of High-rise Building
VENUE : BALLROOM I (2nd floor)			
MODERATOR : BUDI SUSWANTO, ST., MT., PhD			
SESSION II			
No	Name	Presenter	Abstract Title
18	Indra Komara, Endah Wahyuni, Priyo Suprobo and Kivanc Taskin	Indra Komara	EXPERIMENTAL AND NUMERICAL STUDY OF ADHESIVELY BONDED CONNECTION STRENGTH IN COLD-FORMED STEEL ROOF TRUSS CONNECTION
79	Ria Ananda and Iswandi Imran	Ria Ananda	FORCE TRANSFER MECHANISM OF HEADED ANCHORAGE BAR IN EXTERIOR BEAM COLUMN JOINT WITH FINITE ELEMENT METHOD AND STRUT AND TIE MODEL
81	Budi Suswanto, Aniendhita Rizki Amalia and Endah Wahyuni	Budi Suswanto	COMPARISON BETWEEN TUBULAR AND WF LINK OF ECCENTRICALLY BRACED FRAME SYSTEM DUE TO CYCLIC LOADING
102	Kimcheng Kang, Taweeep Chaisomphob and Wasan Patwichaichote	Wasan Patwichaichote	Experimental and Numerical investigation on Cold-formed steel C Back-to-Back beam
118	Libriati Zardasti, Norhazilan Md. Noor and Nordin Yahaya	Libriati Zardasti	PRIORITIZATION OF REPUTATION LOSS FACTORS IMPOSED BY PIPELINE FAILURE SUBJECT TO CORROSION
119	Mathew Harvey Peralta	Mathew Harvey Peralta	Non-Destructive Evaluation of Masonry Materials used in Historic Philippine Structures

VENUE : BALLROOM II (2nd floor)
MODERATOR : DATA IRANATA, ST., MT., PhD

SESSION I

No	Name	Presenter	Abstract Title
2	Hong-An Nguyen and Chatpan Chintanapakdee	Hong-An Nguyen	AN INVESTIGATION ON THE ADAPTIVE MODAL COMBINATION PROCEDURE FOR SEISMIC EVALUATION OF BUILDINGS CONSIDERED SOIL STRUCTURE INTERACTION
12	Harun Alrasyid, Julio Cezar Haryanto, Pujo Aji and Munarus Suluch	Julio Cezar Haryanto	SEISMIC CONFINEMENT DESIGN FOR RECTANGULAR COLUMNS WITH CONSIDERING SHEAR EFFECT
67	Ariella Claresta and Iswandi Imran	Ariella Claresta	SENSITIVITY ANALYSIS OF DAMPING PARAMETERS IN DIRECT DISPLACEMENT BASED DESIGN FOR BRIDGE
72	Duc-Duy Ho and Thanh-Cao Le	Duc-Duy Ho	Advances in Smart Technologies for Structural Health Monitoring of Cable-stayed Bridges
100	Hajar Octariasari, Farid Ma'Ruf and Winda Tri Wahyuningtyas	Farid Ma'Ruf	Numerical analysis on truss bridge performance during structural elements strength reduction
164	Hidajat Sugihardjo, Tavio Tavio and Indrayon Manalu	Hidajat Sugihardjo	SEISMIC STUDY OF APPLICATION OF LEAD RUBBER BEARINGS IN KUTAI KARTANEGARA STEEL ARCH BRIDGE

VENUE : BALLROOM II (2nd floor)
MODERATOR : DATA IRANATA, ST., MT., PhD

SESSION II

No	Name	Presenter	Abstract Title
9	Tri Wulan, Khorin Agus Priadana and Januarti Jaya Ekaputri	Triwulan	Several methods to characterize fly ash quality in the field
13	Syahmi Saari, Badorul Hisham Abu Bakar and Nor Azrina Surip	Syahmi Saari	Flexural Strength of Interlocking Compressed Earth Brick (ICEB) Unit
85	Yvonne William Tonduba and Jahangir Mirza	Yvonne William Tonduba	Strength Activity of Mortar Cement Incorporating Palm Oil Fuel Ash and Fly Ash
90	Chhouk Chhay Horng	Chhouk Chhay Horng	Strength of Timber- Acase study in Cambodia
116	Devi Nuralinah, Sri Murni Dewi, Roland Martin Simatupang and Alwafi Pujiraharjo	Devi Nuralinah	A new pullout test method of bamboo reinforcement with various type and distance of pegs
140	Mustafasanie M Yussof and Gerard Parke	Mustafasanie M Yussof	Glass Stiffness Contribution of Flat and Curved Cable-net Supported Glass Facade Systems

VENUE : TANG PALACE (2nd floor)
MODERATOR : ENDAH WAHYUNI, ST., MSc., PhD

SESSION I

No	Name	Presenter	Abstract Title
27	Harun Alrasyid, Teddy Yustiono, Pujo Aji, Yu Chen-Ou and Yusronia Putri	Teddy Yustiono	Numerical Analysis of Shear Behavior of High-Strength Reinforced Concrete Columns
84	John Pepard Rinchon	John Pepard Rinchon	Strength-Durability Based Design Mix of Self-Compacting Concrete with Ternary Blended Cement using Hybrid Neural Network-Genetic Algorithm
88	Thavera Wihardja and Iswandi Imran	Thavera Wihardja	SEISMIC BEHAVIOUR OF HYBRID COUPLED WALL SYSTEM
108	Khin Su Su Htwe and Yu Pyae Phyo Mon	Khin Su Su Htwe	EFFECT OF NATURAL POZZOLAN ON CARBONATION AND CHLORIDE PENETRATION IN SUSTAINABLE CONCRETE
121	Hla Hla Htay, Htet Thu Aung and Nyan Myint Kyaw	Hla Hla Htay	Experimental Study on Pervious Concrete with Various Mix Ratios
154	Anis Rosyidah, Ferry Hidayat and I Ketut Sucita	Anis Rosyidah	THE BOND STRENGTH OF GLASS FIBER REINFORCED POLYMER (GFRP) REINFORCEMENT WITH MONOLITH CONCRETE

VENUE : TANG PALACE (2nd floor)
MODERATOR : IR. MUDJI IRMAWAN, MS

SESSION II

No	Name	Presenter	Abstract Title
167	Dyah Kusumastuti, Muslinang Moestopo, Mega Suci Ramadhita, Erwin Lim, Randy Tanderan, Undagi Kausar Akbar	Mega Suci Ramadhita	Analytical Investigation of the Applicability of Seismic Devices for Core Frames System in High-Rise Buildings
98	Sigma Wiramadhanesa, I Gusti Putu Raka and Triwulan	Sigma Wiramadhanesa	Flexural Behavior of High Strength Prestressed Concrete In Aggressive Environment
117	Lina Febrianty, I Gusti Putu Raka and Triwulan	Lina Febrianty	FLEXURAL BEHAVIOUR OF HIGH STRENGTH CONCRETE COMPOSITE BEAM AFTER LOADED BY WORKING LOAD ON AGGRESSIVE ENVIRONMENT
127	Candra Irawan, Rudy Djamaluddin, I Gusti Putu Raka, Priyo Suprobo and Gambiro	Priyo Suprobo	CONFINEMENT BEHAVIOR OF SPUN PILE USING LOW AMOUNT OF SPIRAL REINFORCEMENT – AN EXPERIMENTAL STUDY
160	Agustiar Agustiar, Tavio Tavio and Igp Raka	Agustiar	IMPACT OF APPLICATION OF HIGH-STRENGTH CONCRETE AND STEEL ON CONFINEMENT INDEX
176	Bambang Piscesa, Mario M Attard, Ali K. Samani and Priyo Suprobo	Priyo Suprobo	NUMERICAL INVESTIGATION ON THE BEHAVIOR OF CONCRETE-FILLED-STEEL-TUBE (CFST) COLUMN UNDER ECCENTRIC LOADING

DETAILED SCHEDULE OF PARALLEL SESSION BASED ON PAPER IDs [Cont'd]

VENUE :		CELEBES (3rd floor)	
MODERATOR :		Prof. Dr. Ir. Nadjadji Anwar, M.Sc	
SESSION I			
No	Name	Presenter	Abstract Title
19	Abas Pamuji, Sobriyah and Cahyono Ikhsan	Abas Pamuji	THE PREDICTION OF WONOGIRI DAM'S SERVICE LIFE USING POINT INTEGRATED SAMPLING METHOD
21	Windra Iswidodo, Achmad Zubaydi and Agung Budipriyanto	Windra Iswidodo	Sandwich Core Material Development for Ship Deck Structure
22	Syifa Fauziyah, Sobriyah and Cahyono Ikhsan	Syifa Fauziyah	PARABOLIC MODEL OF DEGRADATION AND AGRADATION BASIC RIVER DENGKENG
37	Ayi Syaeful Bahri, Widya Utama, Amien Widodo, Dwa Desa Warnana, Pegri Rohmat, Aripin Aripin, Adib Banuboro and Robi Alfaq Abdillah	Adib Banuboro	3D AQUIFER MODELLING USING RESISTIVITY METHOD (CASE STUDY: SPRINGS OF AIR PDAM SURABAYA, PANDAAN, KABUPATEN PASURUAN)
124	Mohamad Bagus Ansori, Nastasia Festy Margini and Danayanti Azmi Dewi Nusantara	Mohamad Bagus Ansori	STUDY OF IRRIGATION PERFORMANCE AT TERTIARY LEVEL (A CASE STUDY IN PADI POMAHAN IRRIGATION AREA MOJOKERTO EAST JAVA).
152	Lalu Muhamad Jaelani and Rossita Yuli Ratnaningsih	Lalu Muhamad Jaelani	Spatial Distribution and Temporal Analysis of Water Quality Parameter Using Sentinel-2A Data; Case Study: Lake Matano and Towuti
VENUE :		CELEBES (3rd floor)	
MODERATOR :		Dr. techn. Umboro Lasminto, ST, M.Sc	
SESSION II			
No	Name	Presenter	Abstract Title
49	Adhi Muhtadi, Indrasurya B. Mochtar and Hera Widyastuti	Adhi Muhtadi	Best Practice BRT for Increase Transjakarta Modal Share
64	Budi Sugiarto Waloeya and Imma Widyawati Agustin	Budi Sugiarto Waloeya	How to Improve Service Performance of Commuterline in JABODETABEK: A Case Study of Depok to Jakarta Route
66	Imma Widyawati Agustin and Budi Sugiarto Waloeya	Imma Widyawati Agustin	Trip Attraction Model of Land Use for Industrial Area
107	Muhammad Aldhiansyah Rifqi Fauzi and Haryo Dwito Armono	Muhammad Aldhiansyah Rifqi Fauzi and Haryo Dwito Armono	Comparison study of everal Artificial reef type performance to reduce wave height and turbulence intensity
120	Qomarudin Helmy, Suprihanto Notodarmojo, Indah Aruan and Rizki Apriliawati	Qomarudin Helmy	Removal of Color and Chemical Oxygen Demand from Textile Wastewater Using Advanced Oxidation Process (AOPs)
146	Lalu Muhamad Jaelani and Jayed Ali Bachtiar	Lalu Muhamad Jaelani	Implementation of Geoportal for Cultural Heritage Area Preservation of Penanggungan and Trowulan

DETAILED SCHEDULE OF PARALLEL SESSION BASED ON PAPER IDS [Cont'd]

VENUE :		BANDA (3rd floor)	
MODERATOR :		Ir. Hera Widyastuti, MT, Ph.D	
SESSION I			
No	Name	Presenter	Abstract Title
7	Muhammad Hadid, Wahyu Herijanto and Hera Widyastuti	Muhammad Hadid	A SUGGESTED MODEL TO SIMULATE THE DISTANCE BETWEEN INTERSECTION AND U-TURN ON URBAN ROAD (STUDY CASE: MIDDLE EAST RING ROAD, SURABAYA)
24	Agah Muhammad Mulyadi	Agah Muhammad Mulyadi	Motorcycle Red Box Evaluation at Signalized Intersections in Bogor: Traffic Flow, Occupancy Rate and Stop Line Violation
41	Hartono Guntur, Indrasurya B Mochtar and Hera Widyastuti	Hartono Guntur	Modelling Modal Shift Preference of Freight Transport on Surabaya-Jakarta Corridor : A Preliminary Survey
87	Daw Kyaing, Koko Lwin and Yoshihide Sekimoto	Daw Kyaing	Human Mobility Patterns for Different Regions in Myanmar based on CDRs Data
106	Dominic Aloc and Jose Regin Regidor	Dominic Aloc	Re-Imagining Metro Manila: Potential Impacts of Mass Transit for a Megalopolis
112	Ratih Sekartadji, Ervina Ahyudanari and Lalu Muhamad Jaelani	Ratih Sekartadji	Analysis of air traffic density using GIS, Case Study: Jakarta-Surabaya route
VENUE :		BANDA (3rd floor)	
MODERATOR :		Prof.Ir.Indrasurya B. Mochtar, M.Sc, Ph.D	
SESSION II			
No	Name	Presenter	Abstract Title
36	Abdallh Lhwaint, Mohmed Alshekh A. M. Hmade, Ervina Ahyudanari, Indrasurya B Mochtar and Abraham A Ali Blash	Abdallh Lhwaint	ANALYSING PROPERTIES OF ASPHALT CONCRETE MODIFIED WITH CRUMB RUBBER COMPARE TO OTHER MIXTURE
58	Rendy Dwi Pangesti, Ary Setyawan and Budi Yulianto	Rendy Dwi Pangesti	FUNCTIONAL CONDITION RATING SEGMENT SRAGEN RING ROAD SOUTH, CENTRAL JAVA PROVINCE
89	Wahju Herijanto, Indrasurya B. Mochtar and Achmad Wicaksono	Wahju Herijanto	THE INFLUENCE OF GEOGRAPHIC AND SPATIAL POSITION OF RESIDENTIAL ZONES FROM THE ACTIVITIES CENTRES TO ZONAL TRIP GENERATION IN SURABAYA
168	Istiar -, Indrasurya B. Mochtar, Catur Arif Prastyanto and Wahyu Herijanto	Istiar	Taxiway Pavement Evaluation to Support the Operational of Terminal 2 Juanda Airport
169	Anak Agung Gde Kartika, Indrasurya B. Mochtar and Hera Widyastuti	Anak Agung Gde Kartika	The Modelling Concept of Volume and Duration of Parking for Various Types of Landuse in Surabaya.
172	Catur Arif Prastyanto and Indrasurya B Mochtar	Catur Arif Prastyanto	PREDICTION OF FLEXIBLE PAVEMENT DEFLECTION BASED ON FALLING WEIGHT DEFLECTOMETER, FWD, FOR HIGHWAYS TRAVERSED BY HEAVY OVERLOADED VEHICLES (CASE STUDY ON ARTERIAL AND COLLECTOR ROADS IN TUBAN, EAST JAVA, INDONESIA)

DETAILED SCHEDULE OF PARALLEL SESSION BASED ON PAPER IDs [Cont'd]

VENUE : BALI A (3rd floor)			
MODERATOR : Prof. Ir. Noor Endah, M.Sc, Ph.D			
SESSION I			
No	Name	Presenter	Abstract Title
5	Oliver Celis	Oliver Celis	VIABILITY OF PINEAPPLE LEAVES AS AN ALTERNATIVE NATURAL FIBER GEOTEXTILE
16	Jonathan Dungca	Jonathan Dungca	Direct Shear Strength Properties of Limestone-Blended Embankment Materials
32	Chhunla Chheng and Suched Likitlersuang	Suched Likitlersuang	Three-dimensional Finite Element Modelling of Sheet Pile Walls at Deep Excavation in Soft Soils in Bangkok
45	Nu Nu Win	Nu Nu Win	INFLUENCE OF SURCHARGE LOADING AND RETAINED SOIL ON DESIGN OF CONTIGUOUS BORED PILE WALL
105	Hla Myat Htwe and Tun Naing	Hla Myat Htwe	SEEPAGE AND SLOPE STABILITY ANALYSIS OF MYITTHA MULTIPURPOSE DAM PROJECT, GANGAW TOWNSHIP, MAGWAY REGION, MYANMAR
178	Bhagya Jayasinghe, Anthony Goh and Zhiye Zhao	Bhagya Jayasinghe	Numerical analysis of the performance of pile foundations to blast loads
VENUE : BALI A (3rd floor)			
MODERATOR : Dr. Yudhi Lastiasih, ST, MT			
SESSION II			
No	Name	Presenter	Abstract Title
25	Hasbullah Nawir, Bagus Eko Prasetyo and Dayu Apoji	Hasbullah Nawir	Evaluation of Soil Parameters for Excavation Analysis using True Triaxial Test
51	Noor Mochtar and Faisal Yulianto	Faisal Yulianto	COMPRESSION BEHAVIOR OF FIBROUS PEAT STABILIZED WITH ADMIXTURES OF LIME CaCO ₃ +FLY ASH AND LIME CaCO ₃ +RICE HUSH ASH
61	Yudhi Lastiasih, Noor Endah and Farah Nasya	Yudhi Lastiasih	Consolidation Coefficient in Horizontal Direction (Ch) Determined From Field Settlement Data by Using Terzaghi, Asaoka and Finite Element Methods
136	Norhan Abd Rahman and Loke Kok Foong	Norhan Abd Rahman	EXPERIMENTAL STUDY ON HYDROCARBON LIQUIDS MIGRATION IN DOUBLE-POROSITY MEDIUM USING DIGITAL IMAGE ANALYSIS
137	Loke Kok Foong, Norhan Abd. Rahman and Ramli Nazir	Loke Kok Foong	INVESTIGATION OF AQUEOUS AND NON-AQUEOUS PHASE LIQUIDS MIGRATION IN FRACTURED DOUBLE-POROSITY SOIL
182	Jusoh Siti Norafida, Asma'On Siti Aidah, Abdullah Rini Asnida and Marto Aminaton	Jusoh Siti Norafida	Tunnel and microtunnel for future smart and sustainable infrastructure solution

DETAILED SCHEDULE OF PARALLEL SESSION BASED ON PAPER IDs [Cont'd]

VENUE :		JAVA (3rd floor)	
MODERATOR :		Dr.Ipung Fitri Purwanti	
SESSION I			
No	Name	Presenter	Abstract Title
6	Sunik and Very Dermawan	Sunik	WATER QUALITY ANALYSIS OF VILLAGE and MONITORING WELL AROUND REMBANG STEAM POWER PLANT (EIA CASE STUDY in CENTRAL JAVA, INDONESIA)
52	Cho Kyi	Cho Cho Thin Kyi	Water Qauality Assessment ALong Lower Hlaing River
158	Nia Yuniarti Hasan, Driejana and Aminuddin Sulaeman	Nia Yuniarti Hasan	Composition of ions and trace metals in rainwater in Bandung City, Indonesia
163	Theingi Ye Myint, Cho Cho Thin Kyi, Phoo Ei Soe and Shwe Yee Mon Mon	Theingi Ye Myint	Water Quality Assessment of Two Popular Lakes in Yangon, Myanmar
91	Widita Trisniani and Totok Ruki Biyanto	Widita Trisniani	Development of A Phenomenological Fouling Model to Accommodate Characteristics Linear, Exponential and Sigmoid on Heat Exchanger
142	Nida Maisa Zakiyya, Prasanti Widyasih Sarli and Prayatni Soewondo	Prasanti Widyasih Sarli	Correlation Between Visual Improvement and Behaviour Change of Municipal Solid Waste Management in Jodipan and Ksatrian Village, Indonesia
VENUE :		JAVA (3rd floor)	
MODERATOR :		Bieby Voijant Tangahu, Ph.D	
SESSION II			
No	Name	Presenter	Abstract Title
46	Ayi Syaeful Bahri, Pegri Rohmat, Robi Alfaq Abdillah and Adib Banuboro	Pegri Rohmat	Analysis of Seismic Attribute and Band-Limited Inversion to Determining Hydrocarbon Prospect Zone in Data of F3 Netherland
92	Ridho Hantoro, Detak Y. Pratama, Rizky Nanda Puspitasari and Endah Laksmi Nugraha	Endah Laksmi Nugraha	Emission Reduction Study for Eco-Campus Program, Case Study in Sepuluh Nopember Institute of Technology Indonesia
99	Nadiyahatur Rahmatikal Wasiah and Driejana	Nadiyahatur Rahmatikal Wasiah	MODELLING OF TROPOSPHERIC OZONE CONCENTRATION IN URBAN ENVIRONMENT
131	Mochammad Choirul Rizal and Hera Widyastuti	Mochammad Choirul Rizal	NOx Emissions Cost Study Due to Rapid Mass Transport Development Plan (Trem) In Surabaya
138	Adyati Yudison, Driejana Driejana, Iman K. Reksowardojo and Aminudin Sulaeman	Adyati Yudison	Motorcycle Emission Profile Investigation to Support Environmentally Sustainable Transportation in Indonesia
183	Thi Kim Dung Hoang and Phu Khanh Nguyen	Thi Kim Dung Hoang	A Numerical Analysis of Wind Flow in Urban Areas

DETAILED SCHEDULE OF PARALLEL SESSION BASED ON PAPER IDs [Cont'd]

VENUE :		BALI C (3rd floor)	
MODERATOR :		Christiono Utomo, Ph.D	
SESSION I			
No	Name	Presenter	Abstract Title
15	Nur Soleha Abdul Rahim and Sharifah Akmam Syed Zakaria	Nur Soleha Abdul Rahim	THE FRAMEWORK OF BUILDING INFORMATION MODELING (BIM) IMPLEMENTATION STAGES FOR MALAYSIAN CONSTRUCTION INDUSTRY
30	Eko Prihartanto and Muhammad Djaya Bakri	Eko Prihartanto	Identification The Highest Risk Of Performance Based Contract On Road Projects Bojonegoro-Padangan
31	Muhammad Djaya Bakri and Eko Prihartanto	Muhammad Djaya Bakri	Simulation for making Decision of Maintenance highway using Fuzzy Logic (Case Study: The Aki Balak Street, Tarakan City)
34	Fitriah Menufandu	Fitriah Menufandu	LIFE CYCLE COST ANALYSIS (LCCA) APPLICATION OPERATION OF ROAD IN THE DISTRICT SUPIORI PAPUA PROVINCE
59	Muhamad Abduh	Siska Halvireski	Analysis of the Cinapel Bridge's Construction Operations using Simulation
71	Dedy Farhan Fuadie, Christiono Utomo and Yani Rahmawati	Dedy Farhan Fuadie	A Review on Design Error Causal Factors in Construction Project
VENUE :		BALI C (3rd floor)	
MODERATOR :		Christiono Utomo, Ph.D	
SESSION II			
No	Name	Presenter	Abstract Title
74	Reini D Wirahadikusumah, Sapitri, Betty Susanti and Biemo W Soemardi	Sapitri	Risk-Based Government's Estimate for Toll Roads: Investors' Perspectives
111	Herlambang Sucahyo, Yani Rahmawati and Christiono Utomo	Herlambang Sucahyo	A Review on Maximum Productivity of Land Use in Urban Project Development
141	Musyawaroh Musywaroh, Titis Srimuda Pitana, Mohammad Masykuri and Nandariyah Nandariyah	Musyawaroh Musywaroh	Managing Revitalization to Conserve Cultural Heritage Kampong in Kauman Surakarta
144	Agung Sedayu	Agung Sedayu	PROJECT EVALUATION BASED ON SHARIA CONSTRUCTION MANAGEMENT AND GREEN BUILDING PRINCIPLES
150	Nova Nevila Rodhi, Nadjadji Anwar and I Putu Artama Wiguna	I Putu Artama Wiguna	RISK MANAGEMENT EFFECTIVENESS OF PIPELINE INFRASTRUCTURES
175	Christiono Utomo	Christiono Utomo	Negotiation Support for Building Energy System Selection

DETAILED SCHEDULE OF PARALLEL SESSION BASED ON PAPER IDs [Cont'd]

VENUE : BALI B (3rd floor)			
MODERATOR : Ir. I Putu Artama Wiguna, MT, Ph.D			
SESSION I			
No	Name	Presenter	Abstract Title
40	Mohd Azrulfitri Azimi and Sharifah Akmam Syed Zakaria	Mohd Azrulfitri Azimi	Risk Identification of Technical and Non-Technical Factors for Sustainable Coastal Development in Malaysia
50	Khin Aye Mon, Kyaw Kyaw, Zin Mar Lar Tin San, Junji Kiyono, Takeshi Koike, Aung Htet, Chit Nyein Aye and Yin Nwe Oo	Khin Aye Mon	Seismic Risk Analysis for Critical Urban Infrastructure: The Case Study of a Medical Center and its Supporting Systems in Yangon, Myanmar
55	Mahendra Wardhana	Mahendra Wardhana	Minimized Disaster Risk on Multifunction Building through Behavior Analysis Prediction, Density and Usage Movement inside the Building
110	Amien Widodo, Dwa Desa Warnana, Juan Pandu Gya Nur Rochman, Wien Lestari and Ary Iswahyudi	Wien Lestari	TSUNAMI RISK MAPPING OF LUMAJANG DISTRICT USING GEOGRAPHIC INFORMATION SYSTEM(GIS)
130	Aditya Sutantio and I Putu Artama Wiguna	Aditya Sutantio	Investor related Risk Analysis for Development of Apartment Projects: A Literature Review
145	Hery Setiawan Purnawali, Teguh Hariyanto and Nurin Hidayati	Hery Setiawan Purnawali	FLOOD VULNERABILITY ANALYSIS USING REMOTE SENSING AND GIS: A CASE STUDY OF SIDOARJO REGENCY
VENUE : BALI B (3rd floor)			
MODERATOR : Tri Joko Wahyu Adi, ST, MT, Ph.D			
SESSION II			
No	Name	Presenter	Abstract Title
4	Suponco Wisnu Broto, Tri Joko Wahyu Adi, Erma Suryani and Jojok Widodo Soetjipto	Suponco Wisnu Broto	Project Cost Escalation Prediction Models Based on System Dynamics Approach
23	Putri Wardhani, Sobriyah - and Cahyono Ikhsan	Putri Wardhani	The Composite Assessment of River Performance viewed from Function, Structure, Public Participation and Government Regulation
39	Herlina Suciati and Tri Joko Wahyu Adi	Herlina Suciati	A dynamic model for assessing the effects of construction worker behavior to reduce construction waste
93	Franciska Lisa Permatasari, Tri Joko Wahyu Adi and I Putu Artama Wiguna	Franciska Lisa Permatasari	ASSESSMENT MODEL OF CONTRACTOR QUALITY MANAGEMENT MATURITY
113	Diah Sarasanty, Tri Joko Wahyu Adi and I Putu Artama Wiguna	Diah Sarasanty	PROBABILISTIC MODEL FOR PREDICTING CONSTRUCTION WORKER ACCIDENT BASED ON BAYESIAN BELIEF NETWORKS
151	Ahmad Basshofi Habieb	Ahmad Basshofi Habieb	Low Cost Rubber Isolators for Two Stories Masonry Housing in Developing Countries